

Rev	Date	Reference	Drawn / Chk'd
P06	2021/02/14	UTILITY & DRS REVISED.	AA AA

SCHEDULE OF ACCOMMODATION - KEY

Site Area	0.415ha (1.025 acres)
GIA	1,593 sq m
GEA	1,670 sq m
Site Area - Nos. 9 & 9A	0.017ha (0.042 acres)
Sales area	1,025 sq m
WAREHOUSE	
Warehouse	289 sq m
Bakery Warehouse	29 sq m
Additional Chillers	25 sq m
DRS Store	41 sq m
Total Warehouse	384 sq m
ANCILLARY AREA	
Bakery Prep	60 sq m
Cash Office	15 sq m
Utility	12 sq m
Circulation	49 sq m
Internal partitions	48 sq m
Total Ancillary	184 sq m

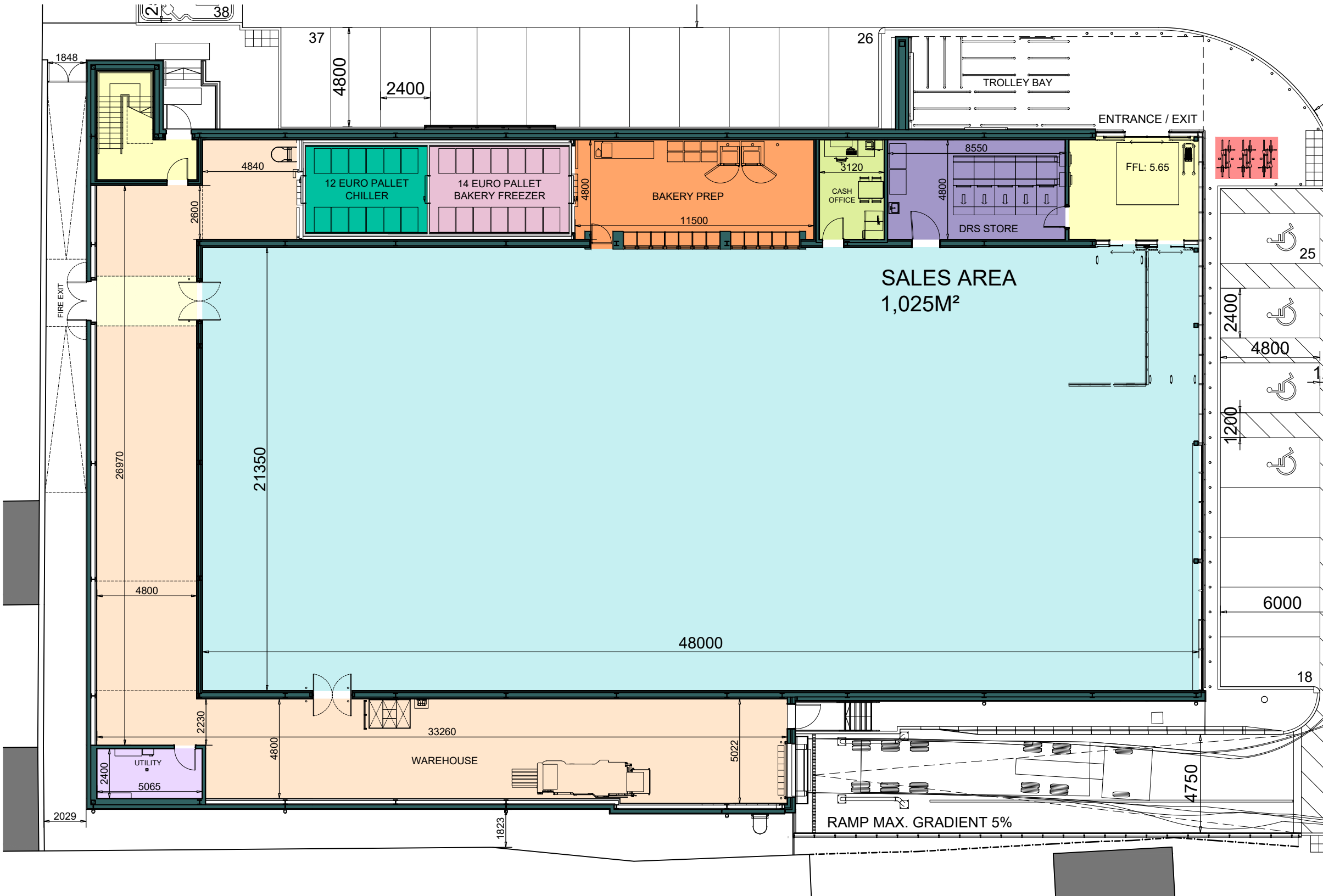

Client

Lidl Great Britain Ltd

Project

Lidl
Rainham Road, Rainham

Title

Store Plan as Proposed

Drawing Ref. Revision

4781-0300 P06

Scale - unless otherwise stated Status Issued For

1:200 @ A3 S0 Preliminary

0 10 20m

Ordnance Survey, (c) Crown Copyright 2019. All rights reserved. Licence number 100022432



KLH architects
The Old Steelyard, Poplar Lane
Sproughton, Ipswich, IP8 3HL
t.01473 689532
klh@klharchitects.com
www.klharchitects.com